



# Badar-Kauffman Conference on Contemporary Issues in Special Education Research

Kent State Hotel and Conference Center  
March 23-25, 2022

## Overview

**Purpose/Goals:** The goal of the Badar-Kauffman Conference is to provide a highly interactive learning experience useful to presenters and audience members alike. All participants have the shared goal of advancing the rigor and utility of scientific research, logical thinking, and conceptual analysis in special education. Attendees are expected to engage in critical discussion on conceptual, methodological, and practical issues.

**Session Formats:** All sessions are intended to be highly interactive. Presentations will occur in the following formats throughout the conference:

**Oral presentations** – Presentations by individuals or groups on a central study or group of studies on a closely related topic. All oral presentations must include 20-30 minutes of time for questions/comments from attendees. Each oral presentation will be assigned a moderator to elicit questions, provide commentary, monitor time, and keep the discussion focused on the session topic.

**Roundtable sessions** – Roundtable sessions are informal discussions around critical topics led by 2-3 highly knowledgeable scholars. Session leaders will pose questions, provide recommendations, and discuss practical scenarios around a topic.

**Networking sessions** – Networking sessions are designed to help early career researchers build their network of professional contacts, collaborators, and friends. *We encourage all attendees to participate.*

**Panel discussion** – A select group of scholars will reflect on the content of presentations, summarize important take-aways, and discuss ways in which the work present may impact special education research in the future.

**Participation:** All presenters are expected to manage time appropriately and reserve ample time for discussion. Audience members are encouraged to engage presenters in collegial, good natured, and professionally useful critique. Attendees are expected to participate in sessions throughout the entirety of the conference.

## Schedule at a Glance

Day	Time	Event	Location
Wednesday (3/23)	4:00 pm-5:00 pm	Registration	Main Hall
	5:00 pm-6:30 pm	Welcome & Keynote	Pizzuti Grand Ballroom
	6:30 pm-8:30 pm	Reception	Pizzuti Grand Ballroom
Thursday (3/24)	8:00 am-10:00 am	Concurrent Sessions	Dix, Kent, McGilvery
	10:15 am-12:15 pm	Concurrent Sessions	Dix, Kent, McGilvery
	<b>12:15 pm-3:15 pm</b>	<b>Mid-day Break or Networking (On Your Own)</b>	
	3:15 pm-5:00 pm	Early Career Networking Session	Laziza (across the street from the hotel)
	5:30 pm-7:00 pm	Poster Session	Pizzuti Grand Ballroom
Friday (3/25)	8:00 am-10:00 am	Concurrent Sessions	Dix, Kent, McGilvery
	10:15 am-12:15 am	Concurrent Sessions	Dix, Kent, McGilvery
	<b>12:15 pm-3:15 pm</b>	<b>Mid-day Break or Networking (On Your Own)</b>	
	3:30 pm-5:00 pm	Roundtable Sessions	Pizzuti Grand Ballroom
	5:30 pm-7:00 pm	Closing Panel and Remarks	Pizzuti Grand Ballroom
	7:30 pm-9:00 pm	Dinner	Pizzuti Grand Ballroom

## Conference Agenda

### *Wednesday, March 23, 2022*

4:00 pm-5:00 pm	Registration	Outside Pizzuti Grand Ballroom
5:00 pm-6:30 pm	Opening Session	Pizzuti Grand Ballroom
	Keynote Presentation – Karen Harris, PhD, Arizona State University	
	<b>Title:</b> Three Decades of Research on Effective Instruction and PD: Lessons Learned and Thoughts on the Future of Special Education Research and Practice.	
6:30 pm-8:30 pm	Evening reception	Pizzuti Grand Ballroom

**Thursday, March 24, 2022**

8:00 am-10:00 am Concurrent Panel Presentations

Room	Title	Presenter(s)	Moderator
Kent	Let's Talk: Addressing and Dissipating Barriers to Adoption and Integration of EBPs	Karen Harris	Rachel Robertson
	When the Evidence Base Fosters Bad Practice: The Case of Fluency Instruction	Deborah Reed	Stephanie Snidarich
Dix	Improving the Reading Comprehension and Writing Abilities of Systems-Involved Youth	Sara Sanders Kristine Jolivet Lauren Hart Rollins	Brian Barber
	The Role of the Home Learning Environment for Children with Speech and/or Language Impairment	Lori Skibbe	Jessica Logan

10:15 am-12:15 pm Concurrent Panel Presentations

Room	Title	Presenter(s)	Moderator
Dix	The Transition Needs of Students with Disabilities in Alternative Education Settings	Olivia Hester Kristine Jolivet Sara Sanders	Emily Tarconish
	The Item Development and Refinement Process of the College and Career Readiness for Transition	Allison Lombardi Graham Rifenbark	Aarti Bellara
Kent	Revitalizing Special Education	James Kauffman Jeanmarie Badar Paige Pullen Tim Landrum Mary Rose Sallese Kimber Vannest Jason Travers Andrew Wiley	Melody Tankersley  Justin Cooper

3:30 pm-5:00 pm Early Career Networking Session (everyone is encouraged to attend) Location: Laziza  
195 Erie St.  
(Across from hotel)

5:30 pm-6:30 pm Poster Session (setup begins at **5:15**) Pizzuti Grand Ballroom

**KENT STATE**  
UNIVERSITY

College of Education,  
Health and Human  
Services

**Friday, March 25, 2022**

8:00 am-10:00 am Concurrent Panel Presentations

Room	Title	Presenter(s)	Moderator
Dix	Diagnostic Accuracy of Spanish and English Screeners with Bilingual Students	Doris Baker Kelli Cummings Keith Smolkowski	Chris Schatschneider
	Bilingual kindergarteners' progress monitoring: The role of probe language and construct dimensionality	Veronica Mellado De La Cruz	Garrett Hall
Kent	Primary and Collateral Effects of a Single Case Intervention for Children with ASD	Naima Bhana Ciara Ousley Atikah Bagawan	Sarah Wilkinson
	Comparing the Cost-Effectiveness of Multiple Approaches to Early Elementary Reading Screening	Adrea Truckenmiller Courtenay Barrett Lindy Johnson	Amanda VanDerHayden
McGilvery	The Telos of Special Education	Mack Burke Lisa Sanchez Nori Ryland	James Kauffman

10:15 am-12:15 pm Concurrent Panel Presentations

Room	Title	Presenter(s)	Moderator
Kent	Using Mixed-effects Regression for Meta-analyses of Single Case Experimental Research	Kyle Wagner Shawn Datchuk Derek Rodgers	Tim Lewis
	Addressing Threats to Internal Validity in Multiple-Baseline Designs	Tim Slocum	Kimber Vannest
Dix	Collaboration Factors in the Cotaught Classroom	Dimitris Anastasiou Tryphon Mavropalias	David Royer
	Improving our scientific research to advance special education	Jason Travers	Eric Common



3:30 pm-5:00 pm Skill Building Roundtable Workshop Sessions Pizzuti Grand Ballroom

Table 1: Data Management, Collection and Visualization for Dissemination

- Jessica Logan,
- Chris Schatschneider

Table 2: Making Friends with Statisticians

- Keith Smolkowski
- Deborah Reed

Table 3: Methodological Standards for Single Case Design

- Karen Harris
- Kimber Vannest

Table 4: Leveraging Social Media for Translation of Research to Practice

- Adrea Truckenmiller
- Shawn Datchuk

5:00 pm-6:30 pm Closing Panel Pizzuti Grand Ballroom

Special education research in the context of contemporary education:  
Unpacking the social, economic, and political climate, and what that  
means for special education research

Panelists: Robin Parks Ennis, University of Alabama at Birmingham  
Aarti Bellara, Ohio State University  
Kimber Vannest, University of Vermont

Moderator: Nate Stevenson, Kent State University

6:30 pm-7:00 pm Business Meeting and Early Career Scholar Award Ceremony

7:00 pm Closing Dinner



## Poster Sessions

---

Poster 1: A Longitudinal Analysis of Response to Treatment for Students with IDD  
Guy Martin, Vanderbilt University

Poster 2: Independent Living Skills Interventions for Students with Autism and Intellectual Disability  
Ashley Taconet, University of Connecticut

Poster 3: Perspectives of College and Career Readiness Among Educational Stakeholders  
Shannon Langdon, University of Connecticut

Poster 4: The Perception of Special Education Teachers in Self-Contained Classrooms in Saudi Arabia  
Shoroq Alkhatabi, University of North Carolina, Greensboro

Poster 5: Self-Regulated Strategy Development: Connecting Persuasive Writing to Self-Determination in Juvenile Justice Facilities  
Allyson Pitzel, University of Alabama

Poster 6: Computational Thinking Instructions for Students with and Without Disabilities in K-12 Settings  
Maryam Nozari, University of Hawaii at Mānoa  
Kavita Rao, University of Hawaii at Mānoa  
Mi Wook Ok, Daegu University

Poster 7: Investigation of An Intervention to Improve On-Task Behavior for Middle Schoolers  
Hani Alanazi, Kent State University  
Nathan Stevenson, Kent State University

Poster 8: Teacher Preparation in Self-Determination Skills: A Pilot Study  
Courtney Cruz, Kent State University

Poster 9: Transition Services: Vocational Outcomes When Given Services Before the Age of Fourteen  
Dylan David, Kent State University

Poster 10: The Use and Misuse of Physical Restraint in School Settings  
Jillian Ali, Kent State University



Poster 11: Arts Based Interventions for Youth With or At-Risk of EBD: A Meta-Analysis  
Alison Kearley, University of Alabama

Poster 12: Comparative Case Study of Two Literacy Settings Mediating Behavior for  
Students with Emotional and Behavioral Disorders  
Elizabeth Hicks, Michigan State University

Poster 13: Examining Early Childhood Teachers' Technology Practices on Children with  
Social/Emotional Development Problems  
Patience Mensah-Bonsu, East Tennessee State University  
VanDyke Adade-Yeboah, Tennessee Tech University

Poster 14: General and Special Education Teachers' Preparedness Towards Teaching  
Young Children with Disabilities  
Jennifer Arthur, Kent State University

Poster 15: Predicting Emotional Disturbance Identification Rates by Political Ideology  
BeckyAnn Harker, Kent State University  
Andrew Wiley, Kent State University

---

### **Conference Planning and Executive Committee**

Nate Stevenson (chair)  
Aarti Bellara  
Ching-I Chen  
Stephanie Snidarich  
Andrew Wiley

### **Conference Advisory Committee**

Jim Kauffman  
Jeanmarie Badar  
Bryan Cook  
Chris Lemons  
Naomi Zigmond



### ***Policy on Professional Discourse and Conduct***

The Badar-Kauffman Conference is dedicated to the advancement of scientific research in special education through discussion and debate that is cordial, professional, respectful, and inclusive of all participants. When providing critique, questions, or responses all attendees are expected to address the merits of the argument and/or evidence, not the individual themselves. Discourse must remain respectful and inclusive at all times. Comments or language that is degrading, disparaging, or disrespectful of any individual or group will not be tolerated. Individuals found in violation of this policy may be subject to removal from the current or future Badar-Kauffman events, and will include forfeiture of registration fees. Any instance in violation of this policy should be reported directly to the Badar-Kauffman Conference Committee.



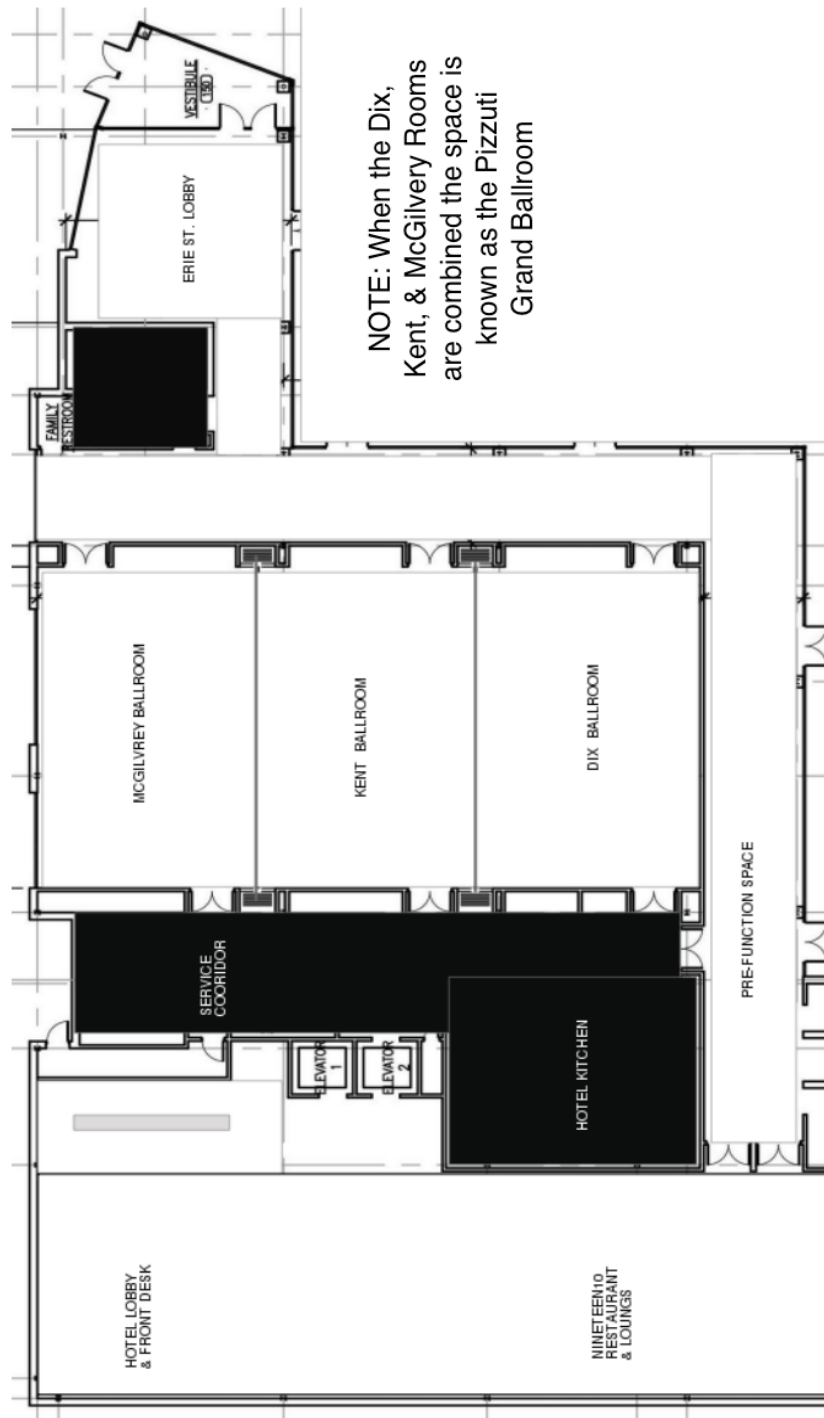

VanDyke	Adade-Yeboah	Tennessee Tech University	vadadeyeb42@tntech.edu
Hatice Nur	Aksu	Kent State University	haksu1@kent.edu
Hani	Alanazi	Kent State University	halanaz2@kent.edu
Shoroq	Alkhatabi	University of North Carolina, Greensboro	soalkhat@uncg.edu
Jillian	Alli	Kent State University	jalli1@kent.edu
Dimitrios	Anastasiou	Southern Illinois University	anastasiou@siu.edu
Jennifer	Arthur	Kent State University	jarthu11@kent.edu
Jeanmarie	Badar		jeanmariebadar@gmail.com
Atikah	Bagawan	Michigan State University	bagawana@msu.edu
Erika	Baisch	Kent State University	ebaisch@kent.edu
Doris	Baker	University of Texas	doris.baker@austin.utexas.edu
Christy	Balan	Kent State University	cbalan@kent.edu
Brian	Barber	Kent State University	bbarber8@kent.edu
Courtenay	Barrett	Michigan State University	morsicou@msu.edu
Peña	Bedesem	Kent State University	pbedesem@kent.edu
Aarti	Bellara	Ohio State University	bellara.1@osu.edu
Bethany	Bennett	Kent State University	bbenne23@kent.edu
Naima	Bhana	Niagara University	nbhana@niagara.edu
Amanda	Boyer	Kent State University	aboyer16@kent.edu
Sloane	Burgess	Kent State University	sburges8@kent.edu
Mack	Burke	Baylor University	Mack_Burke@baylor.edu
Aaron	Campbell	Penn State University	apc6315@psu.edu
Jessica	Cantrell	Kent State University	jcampb71@kent.edu
Paul	Chase	Kent State University	pchase3@kent.edu
Ching-I	Chen	Kent State University	cchen46@kent.edu
Eric	Common	University of Michigan, Flint	ecommon@umflint.edu
Justin	Cooper	University of Louisville	justin.cooper@louisville.edu

Courtney	Cruz	Kent State University	ccruz3@kent.edu
Kelli	Cummings	University of Maryland	kellic@umd.edu
Shawn	Datchuk	University of Iowa	shawn-datchuk@uiowa.edu
Dylan	David	Kent State University	ddavid3@kent.edu
Robin	Ennis	University of Alabama, Birmingham	rennis@uab.edu
Sydney	Fox	Kent State University	sfox43@kent.edu
Garret	Hall	Florida State University	gjhall@fsu.edu
BeckyAnn	Harker	Kent State University	bharker1@kent.edu
Karen	Harris	Arizona State University	karen.r.harris@asu.edu
Lauren	Hart Rollins	University of West Georgia	jrollins@westga.edu
Olivia	Hester	University of Alabama	orhester@ua.edu
Elizabeth	Hicks	Michigan State University	brasseu5@msu.edu
Lindy	Johnson	Michigan State University	john7868@msu.edu
Kristine	Jolivette	The University of Alabama	jolivette@ua.edu
James	Kauffman	University of Virginia	jmk9t@eservices.virginia.edu
Alison	Kearley	The University of Alabama	ankearley@crimson.ua.edu
Morgan	Kirby	Kent State University	mkirby7@kent.edu
Tim	Landrum	University of Louisville	t.landrum@louisville.edu
Shannon	Langdon	University of Connecticut	shannon.langdon@uconn.edu
Tim	Lewis	University of Missouri	lewistj@missouri.edu
Adam	Lockwood	Kent State University	alockwo2@kent.edu
Jessica	Logan	Ohio State University	logan.251@osu.edu
Allison	Lombardi	University of Connecticut	allison.lombardi@uconn.edu
Doris	Luft Baker	University of Texas Austin	doris.baker@austin.utexas.edu
Guy	Martin	Vanderbilt University	guy.martin@vanderbilt.edu
Amanda	Matthews	Kent State University	amatth14@kent.edu
Tryphon	Mavropalias	University of Macedonia	tmavropalias@uowm.gr
Chey	McGough	Kent State University	cmcgough@kent.edu

Veronica	Mellado De La Cruz	Florida Center for Reading Research	vmdlcphd@gmail.com
Patience	Mensah-Bonsu	East Tennessee State University	mensahbonsu@etsu.edu
Kayla Ann	Mullins	Kent State University	kmulli13@kent.edu
Tshebukani	Ncube	Kent State University	tncube1@kent.edu
Jennifer	Newton	Ohio University	newtonj@ohio.edu
Maryam	Nozari	University of Hawaii	nozari@hawaii.edu
Ciara	Ousley	Penn State University	clj54@psu.edu
Allyson	Pitzel	The University of Alabama	aapitzel@crimson.ua.edu
Paige	Pullen	University of Florida	ppullen@coe.ufl.edu
Kavita	Rao	University of Hawaii	kavitar@hawaii.edu
Cam	Ratliff	Kent State University	cratlif4@kent.edu
Deborah	Reed	Iowa Reading Research Center	deborah-reed@uiowa.edu
Graham	Rifenbark	University of Connecticut	graham.rifenbark@uconn.edu
Rachel	Robertson	University of Pittsburgh	RACHELR@pitt.edu
Derek	Rodgers	University of Nebraska-Lincoln	derek.rodgers@unl.edu
David	Royer	University of Louisville	David.royer@louisville.edu
Nori	Ryland	Baylor University	nori_ryland@baylor.edu
Mary Rose	Sallese	University of Alabama, Birmingham	msallese@uab.edu
Lisa	Sanchez	Baylor University	Lisa_Sanchez@baylor.edu
Sara	Sanders	The University of Alabama	sara.sanders@ua.edu
Frank	Sansosti	Kent State University	fsansosti@kent.edu
Chris	Schatschneider	Florida State University	schatschneider@psy.fsu.edu
Lori	Skibbe	Michigan State University	skibbelo@msu.edu
Tim	Slocum	Utah State University	tim.slocum@usu.edu
Keith	Smolkowski	Oregon Research Institute	keiths@ori.org
Stephanie	Snidarich	University of Florida	s.snidarich@coe.ufl.edu



Nathan	Stevenson	Kent State University	nsteve15 @kent.edu
Ashley	Taconet	University of Connecticut	ashley.taconet@uconn.edu
Melody	Tankersley	Kent State University	mtankers@kent.edu
Emily	Tarconish	University of Illinois	ejt@illinois.edu
Jason	Travers	Temple University	jason.travers@temple.edu
Adrea	Truckenmiller	Michigan State University	atruck@msu.edu
Darlene	Unger	Kent State University	dunger1 @kent.edu
Amanda	VanDerHayden	Education Research & Consulting	amandavande@gmail.com
Kimber	Vannest	University of Vermont	Kimberly.Vannest@uvm.edu
Kyle	Wagner	University of Findlay	kyle.wagner@findlay.edu
Theo	Washington III	Kent State University	twashi14@kent.edu
Andrew	Wiley	Kent State University	awiley5@kent.edu
Sarah	Wilkinson	University of Wisconsin, Parkside	wilkinss@uwp.edu
Sonya	Wisdom	Kent State University	swisdom@kent.edu
Min	Wook Ok	Daegu University	minwook.ok@gmail.com