

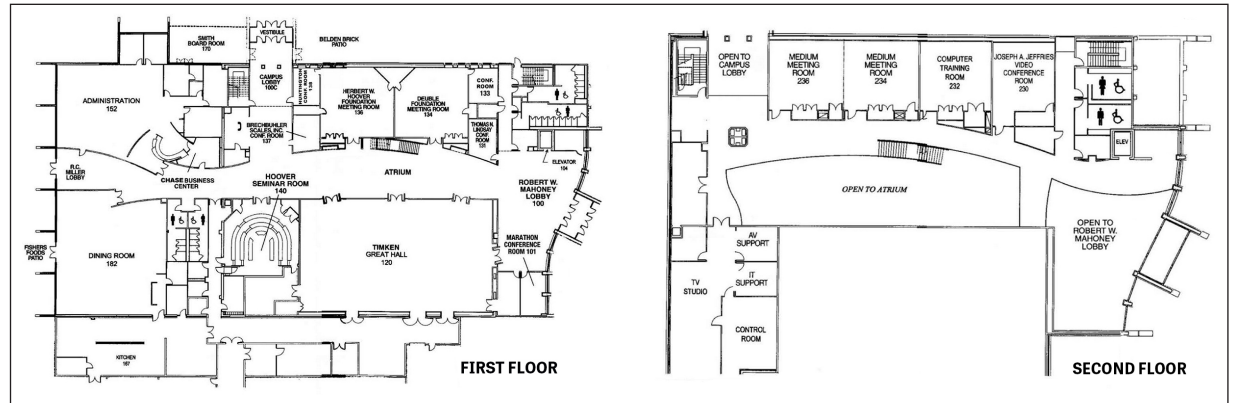

KENT STATE
UNIVERSITY
STARK
CONFERENCE CENTER



Room Specifications

Conference Center Space	Room Number	Dimensions	Square Feet	Theatre	Classroom	U-Shape	Conference Hollow Square	Banquet 72" Round Tables	Pods	Reception
Conference Rooms (5)	101, 131, 133, 137, 138	12 x 23 to 15 x 21	276 to 315				8 - 10			
Medium Meeting Room	232	27 x 26	702	48	32					
Medium Meeting Room (2)	234, 236	27 x 26	702	48	32	18 single U	20		24	70
Medium Meeting Rooms (2) Combined	234 & 236	27 x 26	1430	100	64	30 single U	44		54	140
Large Meeting Rooms	134, 136	36 x 37	1332	90	40	26 single U 34 double U 52 triple U	32		40	133
Hoover Seminar Room	140	35 x 38	1330			53 tiered U				
Joseph A. Jeffries Videoconference Room & Computer Lab	230	22 x 26	572		19 computers					
Smith Board Room	170	19 x 40	760				22			
Timken Great Hall	120	60 x 100	6,000	585	220	77 single U	90	410		600
Timken Great Hall Sections A, B, C (divided into thirds)	120 A 120 B 120 C	33 x 60	1,980	143	56 - 64 per section	34 - 42 per section	48 - 52 per section	90 per section		200
Robert W. Mahoney Lobby		63 x 25	2,157							50 - 75
Atrium		17 x 230	4,848							300 - 400
Campus Lobby	100 C	22 x 59	1,294							75
RC Miller Lobby	100 E	22 x 40	880							75

Contact Us

Janet Capocci, Sales Manager | 330-244-3513 | jcapocci@kent.edu | kent.edu/stark

Kent State University at Stark
Conference Center
6000 Frank Avenue NW
North Canton, Ohio 44720